

# Telephone Pods



PODs

boss



## Range Information

### At a Glance

-  Occupancy: 1 person
-  Delivery & Install NOT included



- 0.25" clear glass panel
- DDA compliant manifestations
- Fully upholstered acoustic wall panels
- 0.3" clear glass pivoting door
- 1.4" satin silver anodised aluminum frame as standard
- Floor fixed
- TP3 allows for vinyl graphics to be placed
- N.B. Acoustic performance is maximized when the pods are positioned on a carpeted surface and acoustic roof mat is selected.



PODS

# Telephone Pod 4 - TP4

Rated up to 34dB



Model	Frame Dimensions (H x W x D)	Description	Price Band 1 Fabric	Price Band 2 Fabric	Price Band 3 Fabric
TP4	W1020mm x D950mm x H2250mm. W40.25" x D37.5" x H80.5"	Fluted Oak	POA	POA	POA
TP4	W1020mm x D950mm x H2250mm. W40.25" x D37.5" x H80.5"	Fluted Black	POA	POA	POA
TP4	W1020mm x D950mm x H2250mm. W40.25" x D37.5" x H80.5"	Oak Relief	POA	POA	POA
TP4	W1020mm x D950mm x H2250mm. W40.25" x D37.5" x H80.5"	White textured	POA	POA	POA

Price does not include packaging. Delivery and/or installation is an additional charge

## Standard Specification

- Satin silver anodised frame
- Levelling plinth, including carpet (Interface Heuga 725 Elephant 672505)
- LED downlight, PIR operated
- Brush Seal to door
- 0.3" toughened glass pivoting door, with latch handle
- 0.25" twin glass rear panels
- 2x Acoustic internal panels, upholstered
- Power supply cable exits under clad panels, 197" cable supplied

## Options - Occupancy Indicator

Options - Occupancy Indicator	\$
Exterior Occupancy Indicator - 2x Sides	POA
Exterior Occupancy Indicator - 1x Sides	POA
Ceiling Mounted, shining upwards (118.25" Ceiling Max)	POA

## Options - Rear Acoustic Panel Upgrade

Options - Rear Acoustic Panel Upgrade	\$
Rear Acoustic Panels - Band 1	POA
Rear Acoustic Panels - Band 2	POA
Rear Acoustic Panels - Band 3	POA

## Options - Frame Handle Finish

Options - Frame Handle Finish	\$
Satin Silver Anodised	POA
Powder Coated ; RAL 7016 / 9003 / 9005	POA
Add lock to latch handle	POA

## Options - Lighting & Airflow

Options - Lighting & Airflow	\$
LED Single Downlight Only	POA
Quad Strip LED lighting, concealed Airflow	POA

## Options - Workshelf & Power/Charging

Options - Workshelf & Power/Charging	\$
8" Deep workshelf	POA
11" Deep workshelf	POA
Phase unit, 1x power, 2x USB Charging (A+C)	POA

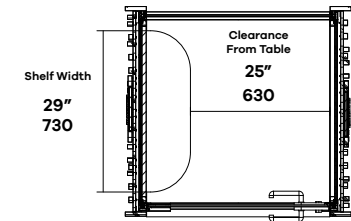

Acoustic performance is maximised when the pods are positioned on a carpeted surface, and when the acoustic roof mat is specified.

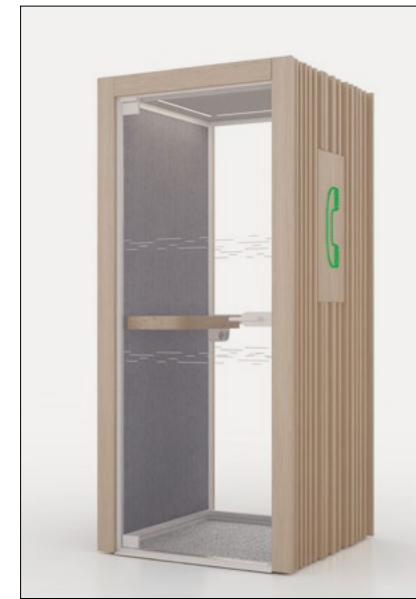

Standard Configuration with Glass Rear



Acoustic Rear Panel Upgrade

## External Pod finishes



Oak Relief



Fluted Black



Fluted Oak



White Textured

## Frame and Handle Finishes

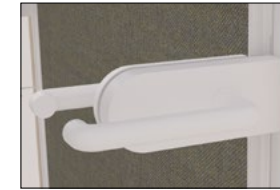

White RAL 9003

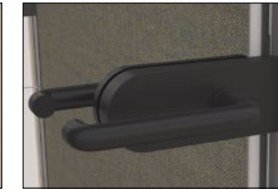

Black RAL 9005

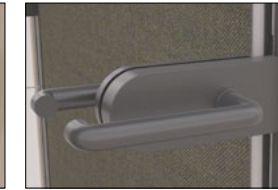

Anthracite RAL 7016



Satin Silver

## Lighting Options



LED Down Light

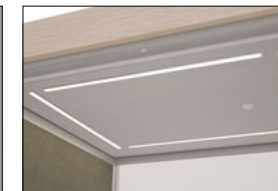

Quad Strip LED Lighting

## Additional Options



Shelf Depth: 200mm or 285mm

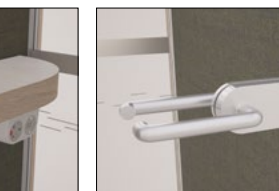

Door Handle Lock

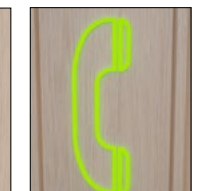

Changing Occupancy Indicator



US Power & USB charge

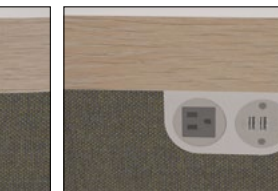

USA Power & USB charge

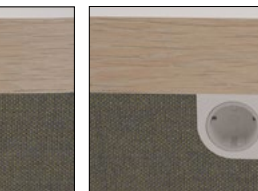

EURO Power & USB charge

## TP4 - Popular Configurations

Rated up to 34dB

### TP4 - Focus Configuration

Dimensions: W1020mm x D950mm x H2250mm  
W40.25" x D37.5" x H80.5"

- Oak relief outer panels
- 2x Camira Synergy acoustic panels
- Floor levelling plinth
- Latch handle
- Powder coated frame and handle - White RAL 9003
- LED light bars to ceiling
- Changing Color Occupancy Phone Logo - RGB LED
- Concealed airflow unit
- D285mm White work table with curved oak edging
- Phase Unit: 1x power + twin USB charge
- PIR Motion/Occupancy Sensor
- DDA compliant manifestations
- 8mm glass door with brush seal

**N.B. Acoustic performance is maximised when the pods are positioned on a carpeted surface.**

**Complete Configuration Price:**

**\$ POA**



### TP4 - Classic Configuration

Dimensions: W1020mm x D950mm x H2250mm  
W40.25" x D37.5" x H80.5"

- Oak relief outer panels
- 2x Kvadrat Remix acoustic panels
- Floor levelling plinth
- Latch handle
- Powder coated frame and handle Anthracite RAL 7016
- LED light bars to ceiling
- Changing Color Occupancy Phone Logo - RGB LED
- Concealed airflow unit
- D200mm White work table with curved oak edging
- Phase Unit: 1x power + twin USB charge
- PIR Motion/Occupancy Sensor
- DDA compliant manifestations
- 8mm glass door with brush seal

**N.B. Acoustic performance is maximised when the pods are positioned on a carpeted surface.**

**Complete Configuration Price:**

**\$ POA**

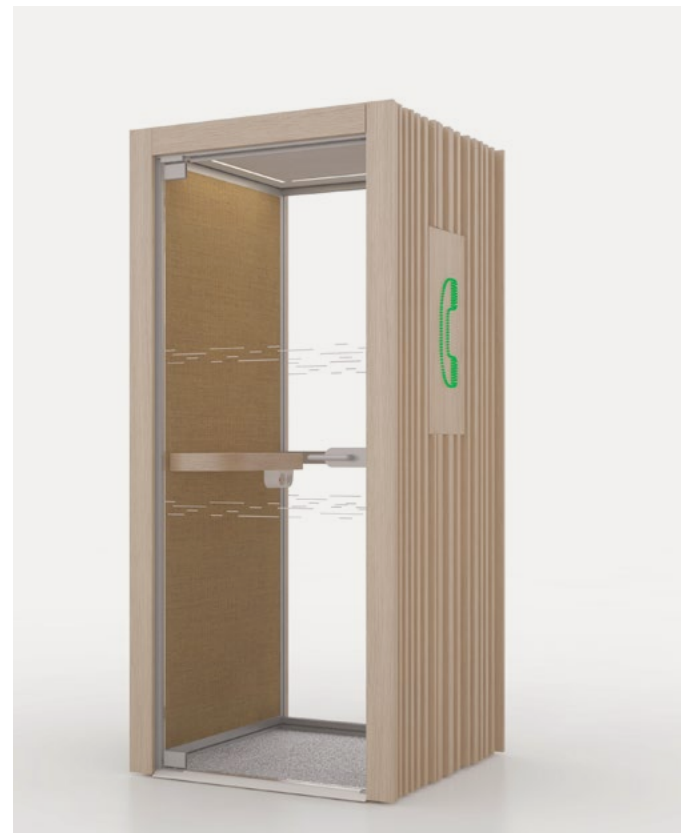

### TP4 - Black Configuration

Dimensions: W1020mm x D950mm x H2250mm  
W40.25" x D37.5" x H80.5"

- Black fluted outer panels
- 2x Kvadrat Remix acoustic panels
- Floor levelling plinth
- Latch handle
- Black powder coated frame and handle Black RAL 9005
- LED light bars to ceiling
- Concealed airflow unit
- D200mm Black work table
- Phase Unit: 1x power + twin USB charge
- PIR Motion/Occupancy Sensor
- DDA compliant manifestations
- 8mm glass door with brush seal

**N.B. Acoustic performance is maximised when the pods are positioned on a carpeted surface.**

**Complete Configuration Price:**

**\$ POA**

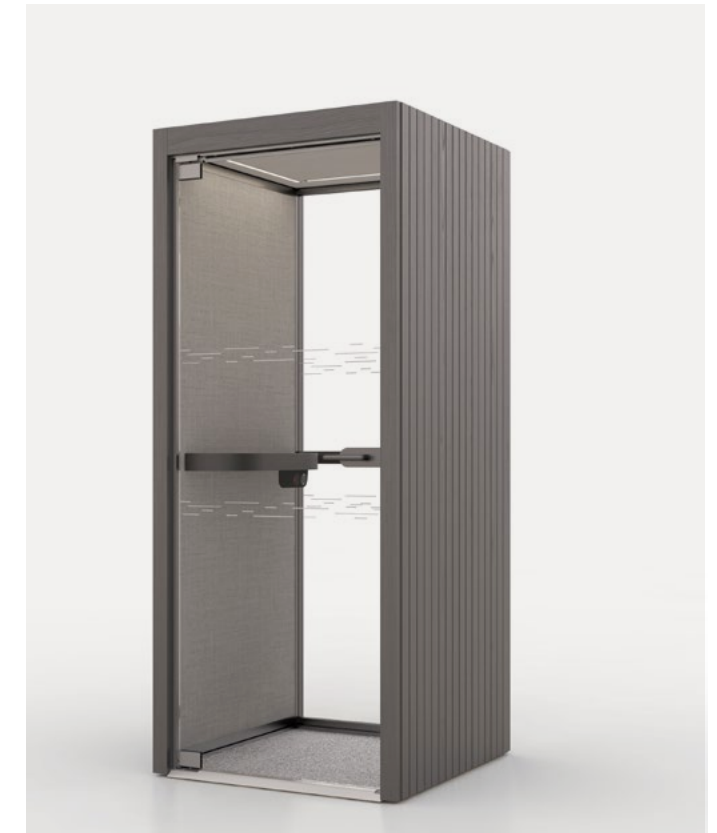

### TP4 - White Configuration

Dimensions: W1020mm x D950mm x H2250mm  
W40.25" x D37.5" x H80.5"

- White relief outer panels
- 2x Camira Synergy acoustic panels
- Floor levelling plinth
- Latch handle
- Black powder coated frame and handle RAL 9005
- LED light bars to ceiling
- Concealed airflow unit
- D200mm White work table
- Phase Unit: 1x power + twin USB charge
- PIR Motion/Occupancy sensor
- DDA compliant manifestations
- 8mm glass door with brush seal

**N.B. Acoustic performance is maximised when the pods are positioned on a carpeted surface.**

**Complete Configuration Price:**

**\$ POA**

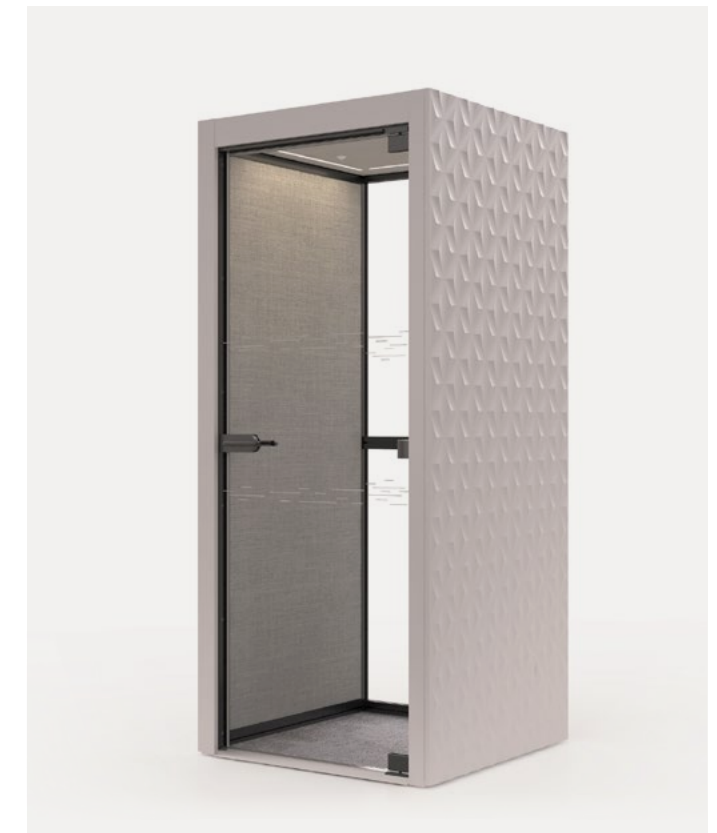

# TP4 - Popular Configurations

Rated up to 34dB

## TP4 - Lite Configuration

Dimensions: W1020mm x D950mm x H2250mm

W40.25" x D37.5" x H80.5"

- Oak fluted outer panels
- 2x Camira Lucia acoustic panels
- Floor levelling plinth
- Latch handle
- Satin Silver powder coated frame and handle
- LED down light
- D200mm White work table with curved oak edging
- PIR Motion/Occupancy Sensor
- DDA compliant manifestations
- 8mm glass door with brush seal

N.B. Acoustic performance is maximised when the pods are positioned on a carpeted surface.



Complete Configuration Price:

\$ POA

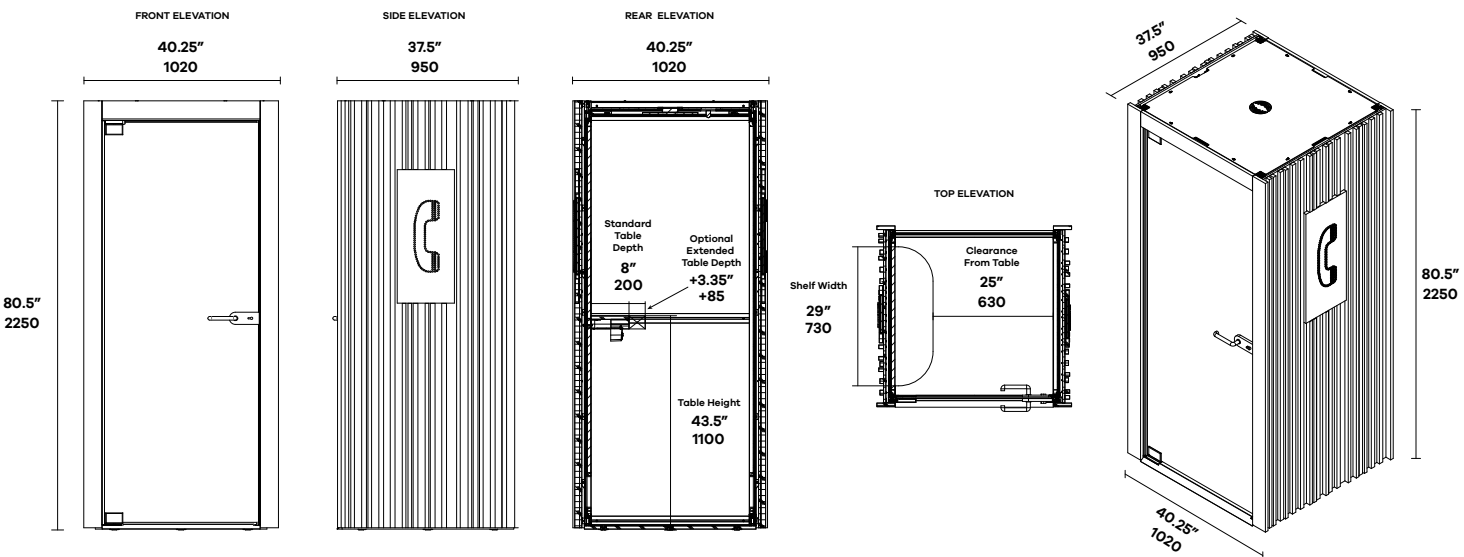

PODS