

### 1. Choose Your Model

The first part of building the product code is to select the seat model of the furniture that you require.

In our example, we are specifying a Myriad 2 seater unit, in 'Two-tone Option 1' (MYR/2/B/TT1)

In this case, we want a grade 3 outer fabric with a grade 5 inner fabric.

**Unit Price: \$3,830**



### 2. Select Your Options

Next you need to select the leg finish. Black, White or an Oak lacquered finish. In our example, we would choose white legs with suffix 'W' to specify a white legged option.

The final unit product code for this specification would be 'MYR/2/B/TT1/W'.

**Options Cost: \$Included**

#### Aluminum Leg

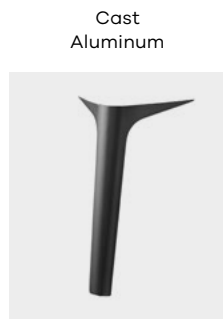

#### Tubular Steel Leg

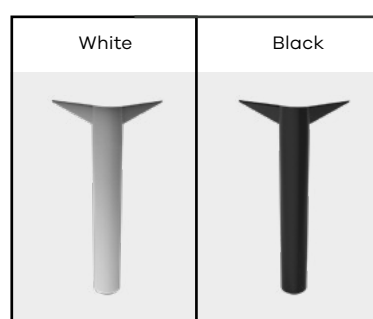

#### Steel & Wooden Leg

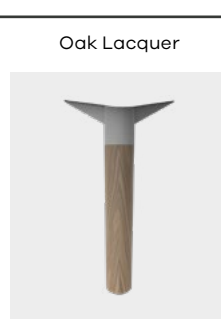

### 3. Optional Extras

From here you can add any options such as tables, screens or arm rests. These feature separate product codes which you add separately to your order.

For example when adding an Oval linking table in Laminate, you would add the code 'MYR/A/TAB/OV/Laminate'.

**Extra Cost: \$502**



See arm options



### Two Seater with Back

MYR/2/B	Fabric Grade Options	Band	Single Fabric			Two-Tone Option 1			Two-Tone Option 2			(ly)	(lb)	
			COM / 1	2	3	4	5	6	7	8	9			10
		-	3524	3620	3730	3804	3934	4026	4192	4378	4616	4838	4.00	84
	Two Tone 1 - TT1	-	Inner Fabric											
		COM / 1	3524	3572	3626	3664	3728	3774	3856	3948	4068	4178	2.00	84
		2	3572	3620	3674	3710	3776	3820	3902	3996	4114	4224	2.00	84
		3	3626	3674	3730	3764	3830	3874	3958	4050	4168	4280	2.00	84
		4	3664	3710	3764	3804	3866	3912	3994	4086	4206	4316	2.00	84
	Outer Fabric	5	3728	3776	3830	3866	3934	3976	4058	4152	4270	4380	2.00	84
		6	3774	3820	3874	3912	3976	4026	4104	4196	4316	4426	2.00	84
		7	3856	3902	3958	3994	4058	4104	4192	4280	4398	4508	2.00	84
		8	3948	3996	4050	4086	4152	4196	4280	4378	4490	4602	2.00	84
		9	4068	4114	4168	4206	4270	4316	4398	4490	4616	4720	2.00	84
		10	4178	4224	4280	4316	4380	4426	4508	4602	4720	4838	2.00	84
	Two Tone 2 - TT2	-	Seat Fabric											
		COM / 1	3608	3702	3810	3884	4014	4104	4268	4454	4692	4912		84
		2	3654	3748	3858	3930	4060	4152	4316	4502	4740	4960		84
		3	3708	3804	3912	3986	4114	4206	4370	4556	4794	5014		84
		4	3746	3840	3948	4022	4152	4242	4406	4592	4830	5050	Seat	84
		5	3810	3904	4014	4086	4216	4308	4472	4658	4896	5116	2.00	84
		6	3856	3950	4058	4132	4262	4352	4518	4702	4940	5162	Back	84
		7	3938	4032	4140	4214	4344	4434	4600	4784	5022	5244	4.00	84
		8	4030	4126	4234	4308	4436	4528	4692	4878	5116	5336		84
		9	4150	4244	4352	4426	4556	4646	4812	4996	5234	5456		84
		10	4260	4354	4462	4536	4666	4756	4922	5106	5344	5566		84

**DIMENSIONS**  
 Height: 790mm (31")  
 Width: 1340mm (52.75")  
 Depth: 670mm (26.5")  
 Seat Height: 460mm (18")

### LEG OPTIONS

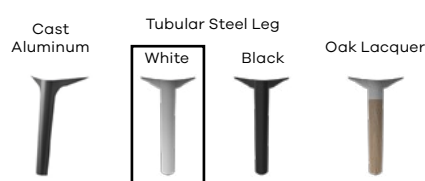

CODE	DESCRIPTION	\$	
CAST ALUMINUM LEG	'B' OR 'W'	Black or white painted cast aluminum leg	No Upcharge
	POLISHED	Polished aluminum leg	No Upcharge
STEEL LEG	'B' OR 'W'	Painted black or white tubular steel leg	No Upcharge
OAK LEG - WHITE COLLAR	Oak lacquered leg with white painted collar	No Upcharge	

MYR/A/TAB... MYRIAD LINKING TABLES.	Code:	Cost Per Unit (\$)		(lb)
		Laminate Top Finish	Veneer Top Finish	
MYR/A/TAB/... Linking Table	MYR/A/TAB/PLEC	502	502	-
	MYR/A/TAB/OV	502	502	-
Linking plate to link seating units. One required per end, per unit. Price PER PLATE	LINKING PLATE	72 Per linking plate		-





### Range Information

- With the increasing need for your furniture to be flexible, Myriad allows you to create a comfortable meeting area, private huddle space or a stunning island. The possibilities are truly infinite with this versatile range.
- Comprehensive range of eleven reconfigurable pieces
- Molded Foam seat and backrest
- Solid plywood internal frame
- Sprung seat
- Clear lacquered Oak, painted tubular steel or cast aluminum leg options
- Choice of black or white painted legs (Other Boss Standard RAL colors available)
- Integrated power and data modules available
- Not recommended to be upholstered in Grade 1 fabrics



### Single Seat



MYR/1	Fabric Grade Options	Band	COM / 1										(ly)	(lb)
			2	3	4	5	6	7	8	9	10			
	Single Fabric	-	2224	2278	2340	2382	2456	2508	2602	2708	2844	2970	2.00	35.5
	Two Tone 1 - TT1	-	IF - Inner Fabric											
	OF - Outer Fabric	COM / 1	2224	2252	2282	2304	2340	2366	2414	2466	2534	2598	1.00	35.5
		2	2252	2278	2310	2330	2368	2394	2440	2494	2562	2624	1.00	35.5
		3	2282	2310	2340	2362	2398	2424	2472	2524	2592	2656	1.00	35.5
		4	2304	2330	2362	2382	2420	2446	2492	2546	2614	2676	1.00	35.5
		5	2340	2368	2398	2420	2456	2482	2530	2582	2650	2714	1.00	35.5
		6	2366	2394	2424	2446	2482	2508	2556	2608	2676	2740	1.00	35.5
		7	2414	2440	2472	2492	2530	2556	2602	2656	2724	2786	1.00	35.5
		8	2466	2494	2524	2546	2582	2608	2656	2708	2776	2840	1.00	35.5
		9	2534	2562	2592	2614	2650	2676	2724	2776	2844	2908	1.00	35.5
		10	2598	2624	2656	2676	2714	2740	2786	2840	2908	2970	1.00	35.5

**DIMENSIONS**  
 Height: 460mm (18")  
 Width: 670mm (26.5")  
 Depth: 670mm (26.5")  
 Seat Height: 460mm (18")

### Single Seat with Back

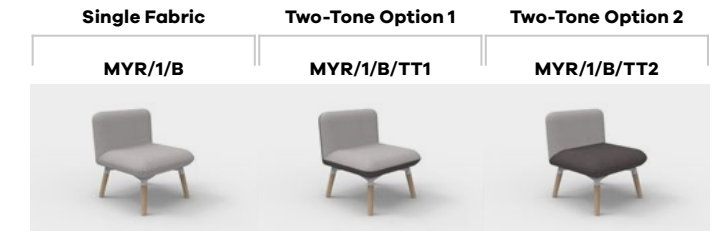

MYR/1/B	Fabric Grade Options	Band	COM / 1										(ly)	(lb)
			2	3	4	5	6	7	8	9	10			
	Single Fabric	-	2854	2908	2970	3012	3086	3138	3232	3338	3474	3600	2.50	53
	Two Tone 1 - TT1	-	Inner Fabric											
	Outer Fabric	COM / 1	2854	2912	2950	2978	3024	3056	3114	3180	3266	3344	1.25	53
		2	2912	2946	2984	3010	3058	3090	3148	3214	3300	3378	1.25	53
		3	2950	2984	3024	3050	3096	3128	3188	3254	3338	3418	1.25	53
		4	2978	3010	3050	3076	3122	3154	3214	3280	3364	3444	1.25	53
		5	3024	3058	3096	3122	3168	3200	3260	3326	3410	3490	1.25	53
		6	3056	3090	3128	3154	3200	3234	3292	3358	3444	3522	1.25	53
		7	3114	3148	3188	3214	3260	3292	3350	3418	3502	3580	1.25	53
		8	3180	3214	3254	3280	3326	3358	3418	3484	3568	3648	1.25	53
		9	3266	3300	3338	3364	3410	3444	3502	3568	3654	3732	1.25	53
		10	3344	3378	3418	3444	3490	3522	3580	3648	3732	3810	1.25	53
	Two Tone 2 - TT2	-	Seat Fabric											
	Back Fabric	COM / 1	2854	2912	2950	2978	3024	3056	3114	3180	3266	3344	1.25	53
		2	2912	2946	2984	3010	3058	3090	3148	3214	3300	3378	1.25	53
		3	2950	2984	3024	3050	3096	3128	3188	3254	3338	3418	1.25	53
		4	2978	3010	3050	3076	3122	3154	3214	3280	3364	3444	1.25	53
		5	3024	3058	3096	3122	3168	3200	3260	3326	3410	3490	1.25	53
		6	3056	3090	3128	3154	3200	3234	3292	3358	3444	3522	1.25	53
		7	3114	3148	3188	3214	3260	3292	3350	3418	3502	3580	1.25	53
		8	3180	3214	3254	3280	3326	3358	3418	3484	3568	3648	1.25	53
		9	3266	3300	3338	3364	3410	3444	3502	3568	3654	3732	1.25	53
		10	3344	3378	3418	3444	3490	3522	3580	3648	3732	3810	1.25	53

**DIMENSIONS**  
 Height: 790mm (31")  
 Width: 670mm (26.5")  
 Depth: 670mm (26.5")  
 Seat Height: 460mm (18")

Fabric Linear Yard Product Weight



## Corner Unit with Back



MYR/C/B	Fabric Grade Options	Band	COM / 1										(ly)	(lb)
			2	3	4	5	6	7	8	9	10			
		-	3970	4046	4132	4190	4292	4364	4494	4640	4828	5002	3.00	70.5
	Two Tone 1 - TT1	-	Inner Fabric											
	Outer Fabric	COM / 1	3970	4054	4108	4144	4210	4254	4336	4430	4548	4658	1.75	70.5
		2	4054	4100	4154	4192	4256	4302	4384	4476	4596	4706	1.75	70.5
		3	4108	4154	4210	4246	4310	4356	4438	4532	4650	4760	1.75	70.5
		4	4144	4192	4246	4282	4348	4392	4476	4568	4686	4798	1.75	70.5
		5	4210	4256	4310	4348	4412	4458	4540	4632	4752	4862	1.75	70.5
		6	4254	4302	4356	4392	4458	4504	4586	4678	4798	4908	1.75	70.5
		7	4336	4384	4438	4476	4540	4586	4668	4760	4880	4990	1.75	70.5
		8	4430	4476	4532	4568	4632	4678	4760	4854	4972	5082	1.75	70.5
		9	4548	4596	4650	4686	4752	4798	4880	4972	5092	5202	1.75	70.5
		10	4658	4706	4760	4798	4862	4908	4990	5082	5202	5312	1.75	70.5
	Two Tone 2 - TT2	-	Seat Fabric											
	Back Fabric	COM / 1	3970	4008	4050	4080	4130	4166	4230	4304	4398	4484	1.75	70.5
		2	4008	4046	4088	4116	4168	4204	4268	4340	4434	4520	1.75	70.5
		3	4050	4088	4132	4160	4210	4246	4310	4384	4476	4564	1.75	70.5
		4	4080	4116	4160	4190	4240	4274	4340	4412	4506	4592	1.75	70.5
		5	4130	4168	4210	4240	4292	4326	4390	4464	4556	4644	1.75	70.5
		6	4166	4204	4246	4274	4326	4364	4426	4498	4592	4680	1.75	70.5
		7	4230	4268	4310	4340	4390	4426	4494	4564	4658	4744	1.75	70.5
		8	4304	4340	4384	4412	4464	4498	4564	4640	4730	4816	1.75	70.5
		9	4398	4434	4476	4506	4556	4592	4658	4730	4828	4910	1.75	70.5
		10	4484	4520	4564	4592	4644	4680	4744	4816	4910	5002	1.75	70.5

**DIMENSIONS**  
 Height: 790mm (31")  
 Width: 670mm (26.5")  
 Depth: 670mm (26.5")  
 Seat Height: 460mm (18")

## Two Seater with Back



MYR/2/B	Fabric Grade Options	Band	COM / 1										(ly)	(lb)
			2	3	4	5	6	7	8	9	10			
		-	3524	3620	3730	3804	3934	4026	4192	4378	4616	4838	4.00	84
	Two Tone 1 - TT1	-	Inner Fabric											
	Outer Fabric	COM / 1	3524	3572	3626	3664	3728	3774	3856	3948	4068	4178	2.00	84
		2	3572	3620	3674	3710	3776	3820	3902	3996	4114	4224	2.00	84
		3	3626	3674	3730	3764	3830	3874	3958	4050	4168	4280	2.00	84
		4	3664	3710	3764	3804	3866	3912	3994	4086	4206	4316	2.00	84
		5	3728	3776	3830	3866	3934	3976	4058	4152	4270	4380	2.00	84
		6	3774	3820	3874	3912	3976	4026	4104	4196	4316	4426	2.00	84
		7	3856	3902	3958	3994	4058	4104	4192	4280	4398	4508	2.00	84
		8	3948	3996	4050	4086	4152	4196	4280	4378	4490	4602	2.00	84
		9	4068	4114	4168	4206	4270	4316	4398	4490	4616	4720	2.00	84
		10	4178	4224	4280	4316	4380	4426	4508	4602	4720	4838	2.00	84
	Two Tone 2 - TT2	-	Seat Fabric											
	Back Fabric	COM / 1	3608	3702	3810	3884	4014	4104	4268	4454	4692	4912	2.00	84
		2	3654	3748	3858	3930	4060	4152	4316	4502	4740	4960	2.00	84
		3	3708	3804	3912	3986	4114	4206	4370	4556	4794	5014	2.00	84
		4	3746	3840	3948	4022	4152	4242	4406	4592	4830	5050	2.00	84
		5	3810	3904	4014	4086	4216	4308	4472	4658	4896	5116	2.00	84
		6	3856	3950	4058	4132	4262	4352	4516	4702	4940	5162	2.00	84
		7	3938	4032	4140	4214	4344	4434	4600	4784	5022	5244	2.00	84
		8	4030	4126	4234	4308	4436	4528	4692	4878	5116	5336	2.00	84
		9	4150	4244	4352	4426	4556	4646	4812	4996	5234	5456	2.00	84
		10	4260	4354	4462	4536	4666	4756	4922	5106	5344	5566	2.00	84

**DIMENSIONS**  
 Height: 790mm (31")  
 Width: 1340mm (52.75")  
 Depth: 670mm (26.5")  
 Seat Height: 460mm (18")

## Two Seat without Back



MYR/2	Fabric Grade Options	Band	COM / 1										(ly)	(lb)
			2	3	4	5	6	7	8	9	10			
	Single Fabric	-	2634	2730	2840	2914	3044	3136	3302	3488	3726	3948	4.00	50.75
	Two Tone 1 - TT1	-	IF - Inner Fabric											
	OF - Outer Fabric	COM / 1	2634	2682	2736	2774	2838	2884	2966	3058	3178	3288	2.00	50.75
		2	2682	2730	2784	2820	2886	2930	3012	3106	3224	3334	2.00	50.75
		3	2736	2784	2840	2874	2940	2984	3068	3160	3278	3390	2.00	50.75
		4	2774	2820	2874	2914	2976	3022	3104	3196	3316	3426	2.00	50.75
		5	2838	2886	2940	2976	3044	3086	3168	3262	3380	3490	2.00	50.75
		6	2884	2930	2984	3022	3086	3136	3214	3306	3426	3536	2.00	50.75
		7	2966	3012	3068	3104	3168	3214	3302	3390	3508	3618	2.00	50.75
		8	3058	3106	3160	3196	3262	3306	3390	3488	3600	3712	2.00	50.75
		9	3178	3224	3278	3316	3380	3426	3508	3600	3726	3830	2.00	50.75
		10	3288	3334	3390	3426	3490	3536	3618	3712	3830	3948	2.00	50.75

**DIMENSIONS**  
 Height: 460mm (18")  
 Width: 1340mm (52.75")  
 Depth: 670mm (26.5")  
 Seat Height: 460mm (18")

## 90° without Back



MYR/90	Fabric Grade Options	Band	COM / 1										(ly)	(lb)
			2	3	4	5	6	7	8	9	10			
	Single Fabric	-	4076	4250	4450	4586	4824	4992	5294	5634	6070	6474	6.00	52
	Two Tone 1 - TT1	-	IF - Inner Fabric											
	OF - Outer Fabric	COM / 1	4076	4164	4262	4330	4448	4532	4682	4852	5068	5270	3.00	52
		2	4164	4250	4348	4416	4534	4618	4768	4938	5156	5356	3.00	52
		3	4262	4348	4450	4516	4634	4716	4868	5036	5254	5456	3.00	52
		4	4330	4416	4516	4586	4700	4784	4934	5104	5322	5524	3.00	52
		5	4448	4534	4634	4700	4824	4902	5052	5222	5440	5642	3.00	52
		6	4532	4618	4716	4784	4902	4992	5136	5306	5524	5724	3.00	52
		7	4682	4768	4868	4934	5052	5136	5294	5456	5674	5876	3.00	52
		8	4852	4938	5036	5104	5222	5306	5456	5634	5844	6044	3.00	52
		9	5068	5156	5254	5322	5440	5524	5674	5844	6070	6262	3.00	52
		10	5270	5356	5456	5524	5642	5724	5876	6044	6262	6474	3.00	52

**DIMENSIONS**  
 Height: 460mm (18")  
 Width: 1340mm (52.75")  
 Depth: 670mm (26.5")  
 Seat Height: 460mm (18")

Fabric Linear Yard Product Weight

Fabric Linear Yard Product Weight

## 90° External Seat

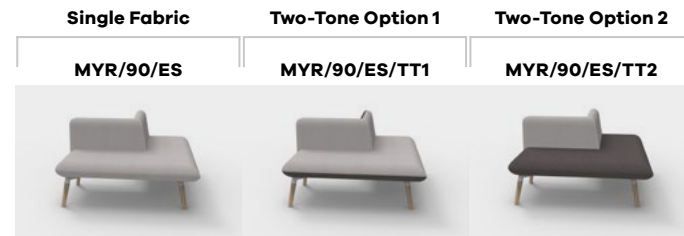

MYR/90/ES	Fabric Grade Options	Band	COM / 1										(ly)	(lb)
			2	3	4	5	6	7	8	9	10			
	-	-	5228	5378	5550	5666	5870	6014	6274	6566	6940	7288	6.00	108
	Two Tone 1 - TT1	-	Inner Fabric											
Outer Fabric	COM / 1	-	5276	5364	5464	5532	5652	5738	5890	6062	6284	6488	Inner 3.00	108
	2	-	5364	5452	5552	5620	5740	5826	5978	6150	6372	6576		
	3	-	5464	5552	5652	5722	5842	5926	6078	6250	6472	6676		
	4	-	5532	5620	5722	5790	5910	5994	6146	6320	6540	6744		
	5	-	5652	5740	5842	5910	6030	6114	6268	6440	6660	6866		
	6	-	5738	5826	5926	5994	6114	6198	6352	6524	6744	6950		
	7	-	5890	5978	6078	6146	6268	6352	6504	6676	6898	7102		
	8	-	6062	6150	6250	6320	6440	6524	6676	6848	7070	7274		
	9	-	6284	6372	6472	6540	6660	6744	6898	7070	7290	7496		
	10	-	6488	6576	6676	6744	6866	6950	7102	7274	7496	7700		
	Two Tone 2 - TT2	-	Seat Fabric											
Back Fabric	COM / 1	-	5240	5336	5444	5518	5646	5738	5902	6088	6326	6546	Seat 3.50	108
	2	-	5302	5396	5504	5578	5708	5798	5962	6148	6386	6606		
	3	-	5372	5466	5574	5648	5778	5868	6032	6218	6456	6676		
	4	-	5418	5512	5622	5694	5824	5916	6080	6266	6504	6724		
	5	-	5502	5596	5704	5778	5908	5998	6164	6348	6586	6808		
	6	-	5560	5654	5764	5836	5966	6058	6222	6408	6646	6866		
	7	-	5666	5760	5868	5942	6072	6162	6328	6512	6750	6972		
	8	-	5786	5880	5988	6062	6192	6282	6446	6632	6870	7090		
	9	-	5938	6032	6142	6214	6344	6436	6600	6786	7024	7244		
	10	-	6080	6174	6282	6356	6486	6576	6742	6926	7164	7386		

**DIMENSIONS**  
 Height: 790mm (31")  
 Width: 1340mm (52.75")  
 Depth: 1340mm (52.75")  
 Seat Height: 460mm (18")

## 90° Internal Seat



MYR/90/IS	Fabric Grade Options	Band	COM / 1										(ly)	(lb)
			2	3	4	5	6	7	8	9	10			
	-	-	5580	5756	5958	6096	6338	6508	6814	7160	7602	8012	7.00	137
	Two Tone 1 - TT1	-	Inner Fabric											
Outer Fabric	COM / 1	-	5592	5680	5782	5850	5970	6054	6206	6380	6600	6804	Inner 3.25	137
	2	-	5688	5774	5876	5944	6064	6148	6302	6474	6694	6900		
	3	-	5796	5884	5984	6052	6172	6258	6410	6582	6804	7008		
	4	-	5870	5956	6058	6126	6246	6330	6484	6656	6876	7082		
	5	-	5998	6086	6188	6256	6376	6460	6612	6786	7006	7210		
	6	-	6090	6178	6278	6346	6466	6552	6704	6876	7098	7302		
	7	-	6254	6342	6442	6510	6632	6716	6868	7040	7262	7466		
	8	-	6440	6528	6628	6696	6816	6902	7054	7226	7448	7652		
	9	-	6678	6766	6866	6934	7054	7140	7292	7464	7686	7890		
	10	-	6898	6986	7086	7154	7276	7360	7512	7684	7906	8110		
	Two Tone 2 - TT2	-	Seat Fabric											
Back Fabric	COM / 1	-	5592	5688	5796	5870	5998	6090	6254	6440	6678	6898	Seat 3.75	137
	2	-	5680	5774	5884	5956	6086	6178	6342	6528	6766	6986		
	3	-	5782	5876	5984	6058	6188	6278	6442	6628	6866	7086		
	4	-	5850	5944	6052	6126	6256	6346	6510	6696	6934	7154		
	5	-	5970	6064	6172	6246	6376	6466	6632	6816	7054	7276		
	6	-	6054	6148	6258	6330	6460	6552	6716	6902	7140	7360		
	7	-	6206	6302	6410	6484	6612	6704	6868	7054	7292	7512		
	8	-	6380	6474	6582	6656	6786	6876	7040	7226	7464	7684		
	9	-	6600	6694	6804	6876	7006	7098	7262	7448	7686	7906		
	10	-	6804	6900	7008	7082	7210	7302	7466	7652	7890	8110		

**DIMENSIONS**  
 Height: 790mm (31")  
 Width: 1340mm (52.75")  
 Depth: 1340mm (52.75")  
 Seat Height: 460mm (18")

Fabric Linear Yard Product Weight

## 120° without Back



MYR/120	Fabric Grade Options	Band	COM / 1										(ly)	(lb)
			2	3	4	5	6	7	8	9	10			
	Single Fabric	-	4168	4290	4430	4526	4694	4812	5024	5264	5570	5854	5.00	59.5
	Two Tone 1 - TT1	-	IF - Inner Fabric											
OF - Outer Fabric	COM / 1	-	4168	4244	4328	4386	4488	4560	4688	4834	5022	5194	Inner 3.00	59.5
	2	-	4216	4290	4376	4434	4536	4606	4736	4882	5068	5242		
	3	-	4270	4344	4430	4488	4590	4660	4790	4936	5122	5296		
	4	-	4308	4382	4466	4526	4626	4698	4826	4972	5160	5332		
	5	-	4372	4446	4532	4590	4694	4762	4892	5038	5224	5398		
	6	-	4418	4492	4576	4634	4736	4812	4938	5082	5270	5444		
	7	-	4500	4574	4660	4716	4818	4890	5024	5166	5352	5526		
	8	-	4592	4666	4752	4810	4912	4982	5112	5264	5444	5618		
	9	-	4712	4786	4870	4928	5030	5102	5232	5376	5570	5738		
	10	-	4822	4896	4982	5038	5140	5212	5342	5488	5674	5854		

**DIMENSIONS**  
 Height: 460mm (18")  
 Width: 2120mm (83.5")  
 Depth: 670mm (26.5")  
 Seat Height: 460mm (18")

## 120° External Seat



MYR/120/ES	Fabric Grade Options	Band	COM / 1										(ly)	(lb)
			2	3	4	5	6	7	8	9	10			
	-	-	5234	5376	5540	5652	5848	5986	6234	6514	6872	7204	6.00	104
	Two Tone 1 - TT1	-	Inner Fabric											
Outer Fabric	COM / 1	-	5246	5320	5406	5464	5566	5638	5766	5912	6100	6272	Inner 3.00	104
	2	-	5320	5396	5480	5538	5640	5712	5840	5986	6174	6346		
	3	-	5406	5480	5566	5624	5726	5796	5926	6072	6258	6432		
	4	-	5464	5538	5624	5682	5782	5854	5984	6130	6316	6490		
	5	-	5566	5640	5726	5782	5884	5956	6086	6232	6418	6592		
	6	-	5638	5712	5796	5854	5956	6028	6156	6302	6490	6662		
	7	-	5766	5840	5926	5984	6086	6156	6286	6432	6618	6792		
	8	-	5912	5986	6072	6130	6232	6302	6432	6578	6764	6938		
	9	-	6100	6174	6258	6316	6418	6490	6618	6764	6952	7124		
	10	-	6272	6346	6432	6490	6592	6662	6792	6938	7124	7298		
	Two Tone 2 - TT2	-	Seat Fabric											
Back Fabric	COM / 1	-	5212	5286	5370	5428	5530	5602	5732	5876	6064	6238	Seat 3.50	104
	2	-	5266	5340	5424	5482	5584	5656	5786	5930	6118	6292		
	3	-	5328	5402	5486	5544	5646	5718	5848	5992	6180	6354		
	4	-	5370	5444	5528	5586	5688	5760	5890	6034	6222	6396		
	5	-	5444	5518	5602	5660	5762	5834	5964	6108	6296	6470		
	6	-	5496	5570	5654	5712	5814	5886	6016	6160	6348	6522		
	7	-	5590	5664	5748	5806	5908	5980	6110	6254	6442	6616		
	8	-	5696	5770	5854	5912	6014	6086	6216	6360	6548	6722		
	9	-	5832	5906	5990	6048	6150	6222	6352	6496	6684	6858		
	10	-	5958	6032	6116	6174	6276	6348	6478	6622	6810	6984		

**DIMENSIONS**  
 Height: 790mm (31")  
 Width: 2120mm (83.5")  
 Depth: 670mm (26.5")  
 Seat Height: 460mm (18")

Fabric Linear Yard Product Weight

# 120° Internal Seat



MYR/120/IS	Fabric Grade Options	Band	COM / 1										(ly)	(lb)
			2	3	4	5	6	7	8	9	10			
		-	5424	5574	5746	5862	6066	6210	6470	6762	7136	7484	6.00	122
	Two Tone 1 - TT1	-	Inner Fabric											
	Outer Fabric	COM / 1	5424	5500	5584	5642	5744	5816	5944	6090	6278	6450	Inner 3.00	122
		2	5500	5574	5658	5716	5818	5890	6018	6164	6352	6524		122
		3	5584	5658	5746	5802	5904	5974	6104	6250	6436	6610		122
		4	5642	5716	5802	5862	5962	6032	6162	6308	6494	6668		122
		5	5744	5818	5904	5962	6066	6134	6264	6410	6596	6770		122
		6	5816	5890	5974	6032	6134	6210	6336	6480	6668	6842		122
		7	5944	6018	6104	6162	6264	6336	6470	6610	6798	6970		122
		8	6090	6164	6250	6308	6410	6480	6610	6762	6942	7116		122
		9	6278	6352	6436	6494	6596	6668	6798	6942	7136	7304		122
		10	6450	6524	6610	6668	6770	6842	6970	7116	7304	7484		122
	Two Tone 2 - TT2	-	Seat Fabric											
	Back Fabric	COM / 1	5424	5500	5584	5642	5744	5816	5944	6090	6278	6450	Seat 3.00	122
		2	5500	5574	5658	5716	5818	5890	6018	6164	6352	6524		122
		3	5584	5658	5746	5802	5904	5974	6104	6250	6436	6610		122
		4	5642	5716	5802	5862	5962	6032	6162	6308	6494	6668		122
		5	5744	5818	5904	5962	6066	6134	6264	6410	6596	6770		122
		6	5816	5890	5974	6032	6134	6210	6336	6480	6668	6842		122
		7	5944	6018	6104	6162	6264	6336	6470	6610	6798	6970		122
		8	6090	6164	6250	6308	6410	6480	6610	6762	6942	7116		122
		9	6278	6352	6436	6494	6596	6668	6798	6942	7136	7304		122
		10	6450	6524	6610	6668	6770	6842	6970	7116	7304	7484		122

**DIMENSIONS**  
 Height: 790mm (31")  
 Width: 2120mm (83.5")  
 Depth: 670mm (26.5")  
 Seat Height: 460mm (18")

Fabric Linear Yard Product Weight

# Huddle



MYR/HUDDLE	Fabric Grade Options	Band	COM / 1										(ly)	(lb)	
			2	3	4	5	6	7	8	9	10				
		-	18512	18952	19454	19792	20386	20806	21564	22414	23504	24518	-	-	
	Two Tone 1 - TT1	-	Inner Fabric												
	Outer Fabric	COM / 1	18512	18824	19094	19280	19604	19830	20240	20704	21300	21850	Outer 3.00	-	-
		2	18824	19060	19330	19514	19840	20064	20474	20940	21534	22084		-	-
		3	19094	19330	19610	19784	20110	20334	20750	21214	21804	22360		-	-
		4	19280	19514	19784	19976	20294	20520	20934	21394	21990	22544		-	-
		5	19604	19840	20110	20294	20626	20844	21254	21720	22314	22864		-	-
		6	19830	20064	20334	20520	20844	21086	21484	21944	22544	23094		-	-
		7	20240	20474	20750	20934	21254	21484	21912	22360	22954	23504		-	-
		8	20704	20940	21214	21394	21720	21944	22360	22842	23414	23970		-	-
		9	21300	21534	21804	21990	22314	22544	22954	23414	24032	24564		-	-
		10	21850	22084	22360	22544	22864	23094	23504	23970	24564	25138		-	-
	Two Tone 2 - TT2	-	Seat Fabric												
	Back Fabric	COM / 1	18764	19122	19530	19812	20302	20644	21264	21970	22872	23704	Back 3.00	-	-
		2	18978	19336	19750	20022	20516	20864	21484	22186	23088	23920		-	-
		3	19224	19588	20000	20278	20762	21110	21730	22436	23334	24170		-	-
		4	19398	19752	20164	20446	20936	21274	21898	22600	23502	24334		-	-
		5	19690	20048	20462	20738	21232	21576	22196	22902	23800	24636		-	-
		6	19900	20258	20666	20944	21438	21784	22406	23102	24004	24846		-	-
		7	20274	20632	21040	21322	21812	22154	22788	23480	24382	25220		-	-
		8	20698	21058	21470	21748	22236	22580	23204	23914	24808	25640		-	-
		9	21246	21600	22008	22290	22780	23122	23752	24448	25358	26188		-	-
		10	21748	22102	22514	22792	23286	23628	24254	24950	25852	26702		-	-

**DIMENSIONS**  
 Height: 790mm (31")  
 Width: 2695mm (106")  
 Depth: 2015mm (79.5")  
 Seat Height: 460mm (18")

Fabric Linear Yard Product Weight

## Myriad Options

LEG OPTIONS	CODE	DESCRIPTION	\$	
	CAST ALUMINUM LEG	'B' OR 'W'	Black or white painted cast aluminum leg	No Upcharge
		POLISHED	Polished aluminum leg	No Upcharge
	STEEL LEG	'B' OR 'W'	Painted black or white tubular steel leg	No Upcharge
	OAK LEG - WHITE COLLAR		Oak lacquered leg with white painted collar	No Upcharge
	OTHER - PAINTED		Painted metal legs (or painted collar) in any standard Boss RAL Color See page 261 for a full list of colors available	70 per leg

MYR/CT/... MYRIAD COFFEE TABLES.	Code:	Description	Laminate Top	(lb)
	MYR/CT/W	Myriad Square Coffee Table - H13.5" x 26.5" (H345 x W670mm) Laminate top with White Painted Steel Legs	1142	-
	MYR/CT/B	Myriad Square Coffee Table - H13.5" x 26.5" (H345 x W670mm) Laminate top with Black Painted Steel Legs	1142	-
	MYR/CT/O	Myriad Square Coffee Table - H13.5" x 26.5" (H345 x W670mm) Laminate top with clear lacquered Oak Legs (Shown Left)	1142	-

MYR/CT/... MYRIAD COFFEE TABLES.	Code:	Description	Laminate Top	(lb)
	MYR/CT/W	Myriad Square Coffee Table - H13.5" x 26.5" (H345 x W670mm) Laminate top with White Painted Steel Legs	1142	-
	MYR/CT/B	Myriad Square Coffee Table - H13.5" x 26.5" (H345 x W670mm) Laminate top with Black Painted Steel Legs	1142	-
	MYR/CT/O	Myriad Square Coffee Table - H13.5" x 26.5" (H345 x W670mm) Laminate top with clear lacquered Oak Legs (Shown Left)	1142	-



# Crescent



MYR/CRESCENT	Fabric Grade Options	Band	COM / 1	2	3	4	5	6	7	8	9	10	(ly)	(lb)
4x MYR/120/IS units		-	16272	16722	17238	17586	18198	18630	19410	20286	21408	22452	-	-
	<b>Two Tone 1 - TT1</b>	-	<b>Inner Fabric</b>											
	<b>Outer Fabric</b>	COM / 1	16272	16500	16752	16926	17232	17448	17832	18270	18834	19350	-	-
		2	16500	16722	16974	17148	17454	17670	18054	18492	19056	19572	-	-
		3	16752	16974	17238	17406	17712	17922	18312	18750	19308	19830	-	-
		4	16926	17148	17406	17586	17886	18096	18486	18924	19482	20004	-	-
		5	17232	17454	17712	17886	18198	18402	18792	19230	19788	20310	-	-
		6	17448	17670	17922	18096	18402	18630	19008	19440	20004	20526	-	-
		7	17832	18054	18312	18486	18792	19008	19410	19830	20394	20910	-	-
		8	18270	18492	18750	18924	19230	19440	19830	20286	20826	21348	-	-
		9	18834	19056	19308	19482	19788	20004	20394	20826	21408	21912	-	-
		10	19350	19572	19830	20004	20310	20526	20910	21348	21912	22452	-	-
	<b>Two Tone 2 - TT2</b>	-	<b>Seat Fabric</b>											
	<b>Back Fabric</b>	COM / 1	16272	16500	16752	16926	17232	17448	17832	18270	18834	19350	-	-
		2	16500	16722	16974	17148	17454	17670	18054	18492	19056	19572	-	-
		3	16752	16974	17238	17406	17712	17922	18312	18750	19308	19830	-	-
		4	16926	17148	17406	17586	17886	18096	18486	18924	19482	20004	-	-
		5	17232	17454	17712	17886	18198	18402	18792	19230	19788	20310	-	-
		6	17448	17670	17922	18096	18402	18630	19008	19440	20004	20526	-	-
		7	17832	18054	18312	18486	18792	19008	19410	19830	20394	20910	-	-
		8	18270	18492	18750	18924	19230	19440	19830	20286	20826	21348	-	-
		9	18834	19056	19308	19482	19788	20004	20394	20826	21408	21912	-	-
		10	19350	19572	19830	20004	20310	20526	20910	21348	21912	22452	-	-

**DIMENSIONS**  
 Height: **790mm (31")**  
 Width: **3690mm (145.25")**  
 Depth: **2125mm (83.5")**  
 Seat Height: **460mm (18")**

Fabric Linear Yard Product Weight

# Propeller



MYR/PROPELLER	Fabric Grade Options	Band	COM / 1	2	3	4	5	6	7	8	9	10	(ly)	(lb)
3x MYR/120/IS units		-	16272	16722	17238	17586	18198	18630	19410	20286	21408	22452	-	-
	<b>Two Tone 1 - TT1</b>	-	<b>Inner Fabric</b>											
	<b>Outer Fabric</b>	COM / 1	16272	16500	16752	16926	17232	17448	17832	18270	18834	19350	-	-
		2	16500	16722	16974	17148	17454	17670	18054	18492	19056	19572	-	-
		3	16752	16974	17238	17406	17712	17922	18312	18750	19308	19830	-	-
		4	16926	17148	17406	17586	17886	18096	18486	18924	19482	20004	-	-
		5	17232	17454	17712	17886	18198	18402	18792	19230	19788	20310	-	-
		6	17448	17670	17922	18096	18402	18630	19008	19440	20004	20526	-	-
		7	17832	18054	18312	18486	18792	19008	19410	19830	20394	20910	-	-
		8	18270	18492	18750	18924	19230	19440	19830	20286	20826	21348	-	-
		9	18834	19056	19308	19482	19788	20004	20394	20826	21408	21912	-	-
		10	19350	19572	19830	20004	20310	20526	20910	21348	21912	22452	-	-
	<b>Two Tone 2 - TT2</b>	-	<b>Seat Fabric</b>											
	<b>Back Fabric</b>	COM / 1	16272	16500	16752	16926	17232	17448	17832	18270	18834	19350	-	-
		2	16500	16722	16974	17148	17454	17670	18054	18492	19056	19572	-	-
		3	16752	16974	17238	17406	17712	17922	18312	18750	19308	19830	-	-
		4	16926	17148	17406	17586	17886	18096	18486	18924	19482	20004	-	-
		5	17232	17454	17712	17886	18198	18402	18792	19230	19788	20310	-	-
		6	17448	17670	17922	18096	18402	18630	19008	19440	20004	20526	-	-
		7	17832	18054	18312	18486	18792	19008	19410	19830	20394	20910	-	-
		8	18270	18492	18750	18924	19230	19440	19830	20286	20826	21348	-	-
		9	18834	19056	19308	19482	19788	20004	20394	20826	21408	21912	-	-
		10	19350	19572	19830	20004	20310	20526	20910	21348	21912	22452	-	-

**DIMENSIONS**  
 Height: **790mm (31")**  
 Width: **2140mm (84.25")**  
 Depth: **2430mm (95.75")**  
 Seat Height: **460mm (18")**

Fabric Linear Yard Product Weight

MYR/CT/... MYRIAD COFFEE TABLES.	Code:	Description	Laminate Top	(lb)
	<b>MYR/CT/W</b>	Myriad Square Coffee Table - H13.5" x 26.5" (H345 x W670mm) Laminate top with White Painted Steel Legs	1142	-
	<b>MYR/CT/B</b>	Myriad Square Coffee Table - H13.5" x 26.5" (H345 x W670mm) Laminate top with Black Painted Steel Legs	1142	-
	<b>MYR/CT/O</b>	Myriad Square Coffee Table - H13.5" x 26.5" (H345 x W670mm) Laminate top with clear lacquered Oak Legs (Shown Left)	1142	-

MYR/CT/... MYRIAD COFFEE TABLES.	Code:	Description	Laminate Top	(lb)
	<b>MYR/CT/W</b>	Myriad Square Coffee Table - H13.5" x 26.5" (H345 x W670mm) Laminate top with White Painted Steel Legs	1142	-
	<b>MYR/CT/B</b>	Myriad Square Coffee Table - H13.5" x 26.5" (H345 x W670mm) Laminate top with Black Painted Steel Legs	1142	-
	<b>MYR/CT/O</b>	Myriad Square Coffee Table - H13.5" x 26.5" (H345 x W670mm) Laminate top with clear lacquered Oak Legs (Shown Left)	1142	-





# Cruciform



MYR/CRUCIFORM	Fabric Grade Options	Band	COM / 1	2	3	4	5	6	7	8	9	10	(ly)	(lb)
		-	22320	23024	23832	24384	25352	26032	27256	28640	30408	32048	-	-
	Two Tone 1 - TT1	-	Inner Fabric											
	Outer Fabric	COM / 1	22368	22720	23128	23400	23880	24216	24824	25520	26400	27216	-	-
		2	22752	23096	23504	23776	24256	24592	25208	25896	26776	27600	-	-
		3	23184	23536	23936	24208	24688	25032	25640	26328	27216	28032	-	-
		4	23480	23824	24232	24504	24984	25320	25936	26624	27504	28328	-	-
		5	23992	24344	24752	25024	25504	25840	26448	27144	28024	28840	-	-
		6	24360	24712	25112	25384	25864	26208	26816	27504	28392	29208	-	-
		7	25016	25368	25768	26040	26528	26864	27472	28160	29048	29864	-	-
		8	25760	26112	26512	26784	27264	27608	28216	28904	29792	30608	-	-
		9	26712	27064	27464	27736	28216	28560	29168	29856	30744	31560	-	-
		10	27592	27944	28344	28616	29104	29440	30048	30736	31624	32440	-	-
	Two Tone 2 - TT2	-	Seat Fabric											
	Back Fabric	COM / 1	22368	22720	23128	23400	23880	24216	24824	25520	26400	27216	-	-
		2	22752	23096	23504	23776	24256	24592	25208	25896	26776	27600	-	-
		3	23184	23536	23936	24208	24688	25032	25640	26328	27216	28032	-	-
		4	23480	23824	24232	24504	24984	25320	25936	26624	27504	28328	-	-
		5	23992	24344	24752	25024	25504	25840	26448	27144	28024	28840	-	-
		6	24360	24712	25112	25384	25864	26208	26816	27504	28392	29208	-	-
		7	25016	25368	25768	26040	26528	26864	27472	28160	29048	29864	-	-
		8	25760	26112	26512	26784	27264	27608	28216	28904	29792	30608	-	-
		9	26712	27064	27464	27736	28216	28560	29168	29856	30744	31560	-	-
		10	27592	27944	28344	28616	29104	29440	30048	30736	31624	32440	-	-

**DIMENSIONS**

Height: **790mm (31")**  
 Width: **2690mm (106")**  
 Depth: **2690mm (106")**  
 Seat Height: **460mm (18")**

Fabric Linear Yard Product Weight

MYR/CT/... MYRIAD COFFEE TABLES.	Code:	Description	Laminate Top	(lb)
	MYR/CT/W	Myriad Square Coffee Table - H13.5" x 26.5" (H345 x W670mm) Laminate top with White Painted Steel Legs	1142	-
	MYR/CT/B	Myriad Square Coffee Table - H13.5" x 26.5" (H345 x W670mm) Laminate top with Black Painted Steel Legs	1142	-
	MYR/CT/O	Myriad Square Coffee Table - H13.5" x 26.5" (H345 x W670mm) Laminate top with clear lacquered Oak Legs (Shown Left)	1142	-

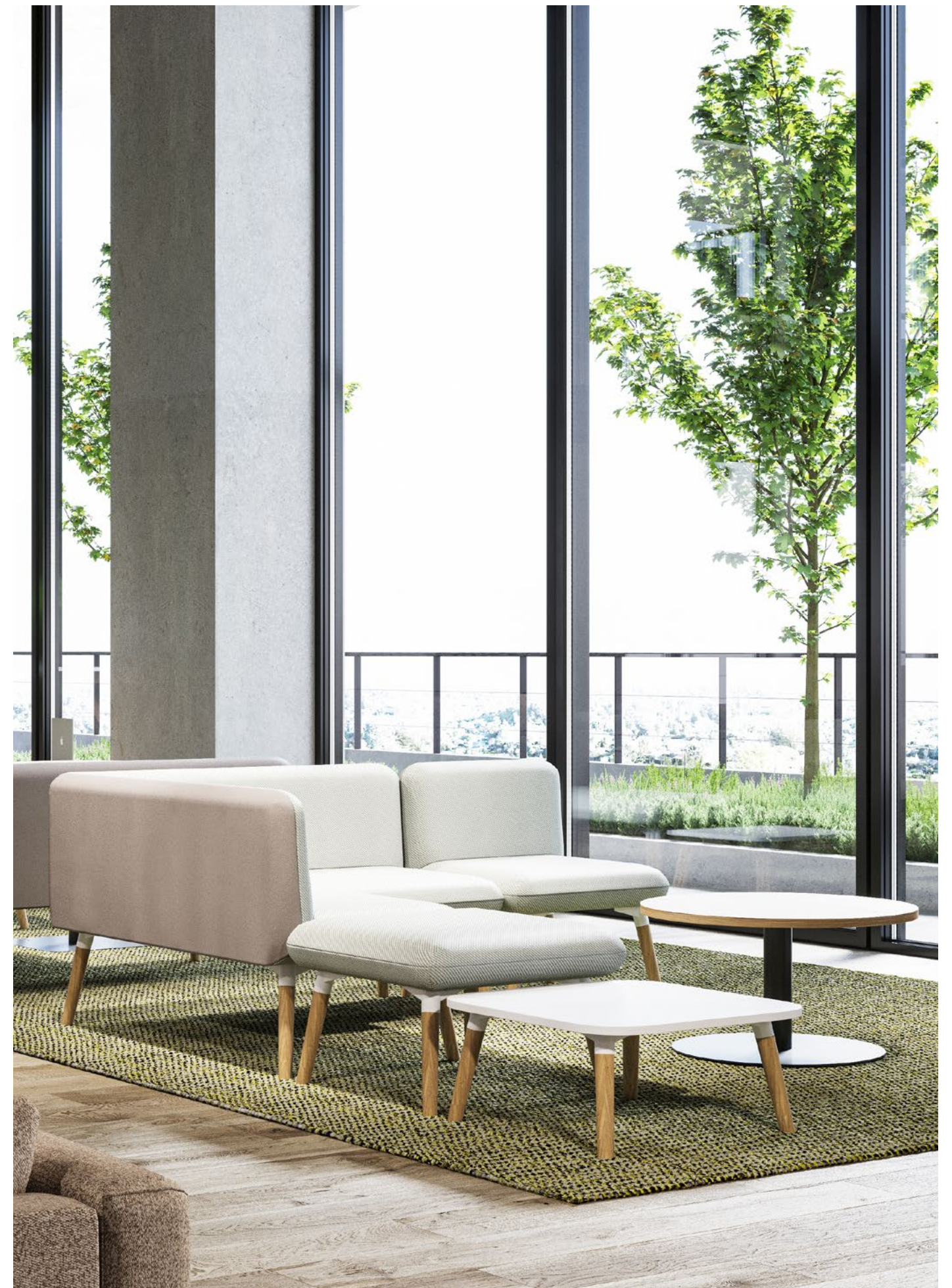
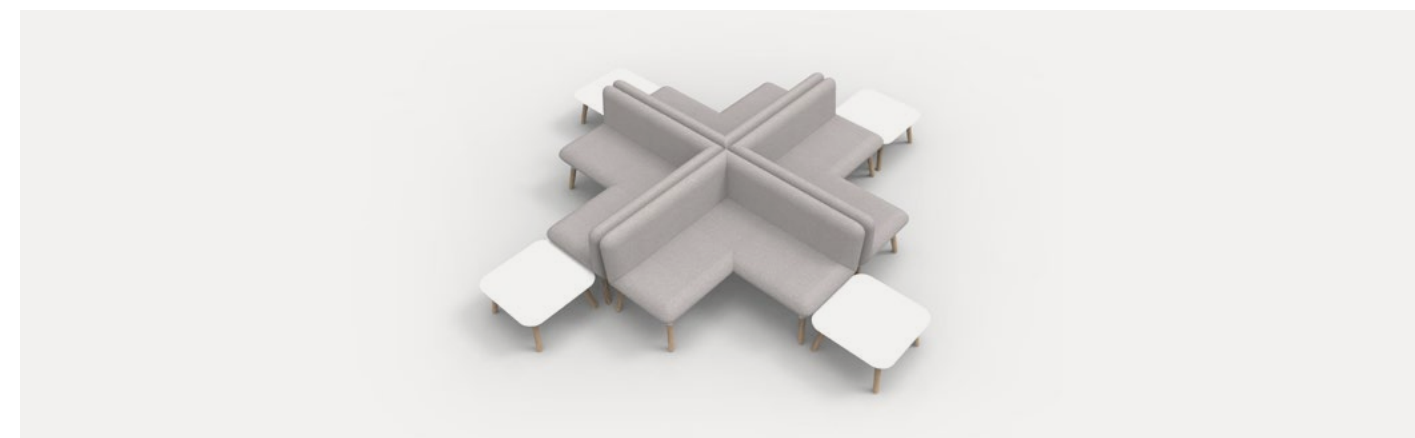

MODULAR SEATING SYSTEMS



MYR/S... MYRIAD SCREENS.	Fabric Grade Options	Band	COM /1	2	3	4	5	6	7	8	9	10	(ly)	(lb)
<b>MYR/S1</b> High Double Screen H55" x W52.75" (H1400mm x W1340mm) with black or white painted feet.	Single OR Two Tone (Front/Back)	COM /1	1126	1174	1228	1266	1330	1376	1458	1550	1670	1780	-	-
		2	1174	1222	1276	1312	1378	1422	1504	1598	1716	1826	-	-
		3	1228	1276	1332	1366	1432	1476	1560	1652	1770	1882	-	-
		4	1266	1312	1366	1406	1468	1514	1596	1688	1808	1918	Single Fabric 4.00	-
		5	1330	1378	1432	1468	1536	1578	1660	1754	1872	1982	-	-
		6	1376	1422	1476	1514	1578	1628	1706	1798	1918	2028	Two Tone 2.00 x2	-
		7	1458	1504	1560	1596	1660	1706	1794	1882	2000	2110	-	-
		8	1550	1598	1652	1688	1754	1798	1882	1980	2092	2204	-	-
		9	1670	1716	1770	1808	1872	1918	2000	2092	2218	2322	-	-
		10	1780	1826	1882	1918	1982	2028	2110	2204	2322	2440	-	-
<b>MYR/S2</b> High Single Screen H55" x W26.5" (H1400mm x W670mm) with black or white painted feet.	Single OR Two Tone (Front/Back)	COM /1	992	1020	1050	1072	1108	1134	1182	1234	1302	1366	-	-
		2	1020	1046	1078	1098	1136	1162	1208	1262	1330	1392	-	-
		3	1050	1078	1108	1130	1166	1192	1240	1292	1360	1424	-	-
		4	1072	1098	1130	1150	1188	1214	1260	1314	1382	1444	Single Fabric 2.00	-
		5	1108	1136	1166	1188	1224	1250	1298	1350	1418	1482	-	-
		6	1134	1162	1192	1214	1250	1276	1324	1376	1444	1508	Two Tone 1.00 x2	-
		7	1182	1208	1240	1260	1298	1324	1370	1424	1492	1554	-	-
		8	1234	1262	1292	1314	1350	1376	1424	1476	1544	1608	-	-
		9	1302	1330	1360	1382	1418	1444	1492	1544	1612	1676	-	-
		10	1366	1392	1424	1444	1482	1508	1554	1608	1676	1738	-	-
<b>MYR/S3</b> Low Double Screen H43" x W52.75" (H1090mm x W1340mm) with black or white painted feet.	Single OR Two Tone (Front/Back)	COM /1	1030	1072	1118	1150	1204	1244	1314	1394	1496	1590	-	-
		2	1072	1112	1158	1190	1246	1284	1354	1434	1536	1630	-	-
		3	1118	1158	1206	1236	1292	1330	1402	1480	1582	1678	-	-
		4	1150	1190	1236	1270	1324	1362	1432	1512	1614	1708	Single Fabric 3.00	-
		5	1204	1246	1292	1324	1382	1418	1488	1568	1670	1764	-	-
		6	1244	1284	1330	1362	1418	1460	1528	1606	1708	1804	Two Tone 1.50 x2	-
		7	1314	1354	1402	1432	1488	1528	1602	1678	1780	1874	-	-
		8	1394	1434	1480	1512	1568	1606	1678	1762	1858	1954	-	-
		9	1496	1536	1582	1614	1670	1708	1780	1858	1966	2056	-	-
		10	1590	1630	1678	1708	1764	1804	1874	1954	2056	2156	-	-

MYR/A/TAB... MYRIAD LINKING TABLES.	Code:	Cost Per Unit (\$)		(lb)
		Laminate Top Finish	Veneer Top Finish	
MYR/A/TAB/... Linking Table	MYR/A/TAB/PLEC	502	502	-
	MYR/A/TAB/OV	502	502	-
Linking plate to link seating units. One required per end, per unit. Price PER PLATE	LINKING PLATE	72 Per linking plate		-

MYR/A... ARM UNITS	Fabric Grade Options	Band	COM /1	2	3	4	5	6	7	8	9	10	(ly)	(lb)	
<b>MYR/A</b> Upholstered arm with linking support bracket, no power.	Single Fabric	-	874	916	964	996	1052	1092	1164	1244	1346	1442	1.50	-	
	Two Tone 1	-	Top										-	-	
		Bottom	COM /1	874	896	918	934	962	982	1016	1056	1108	1154	-	-
			2	896	916	938	954	982	1002	1036	1076	1128	1174	-	-
			3	918	938	964	978	1006	1024	1060	1100	1150	1198	-	-
			4	934	954	978	996	1022	1040	1076	1116	1166	1214	Single Fabric	-
			5	962	982	1006	1022	1052	1068	1104	1144	1194	1242	-	-
			6	982	1002	1024	1040	1068	1092	1124	1162	1214	1262	0.75 x2	-
			7	1016	1036	1060	1076	1104	1124	1164	1198	1250	1296	-	-
			8	1056	1076	1100	1116	1144	1162	1198	1244	1288	1336	-	-
9			1108	1128	1150	1166	1194	1214	1250	1288	1346	1388	-	-	
10			1154	1174	1198	1214	1242	1262	1296	1336	1388	1442	-	-	
<b>MYR/A/PIX1</b> Upholstered arm with linking support bracket, 1x White Pixel 1x power and 1x TUF with a 10' (3m) starter lead.	Single Fabric	-	1226	1268	1316	1348	1404	1444	1516	1596	1698	1794	1.50	-	
	Two Tone 1	-	Top										-	-	
		Bottom	COM /1	1226	1248	1270	1286	1314	1334	1368	1408	1460	1506	-	-
			2	1248	1268	1290	1306	1334	1354	1388	1428	1480	1526	-	-
			3	1270	1290	1316	1330	1358	1376	1412	1452	1502	1550	-	-
			4	1286	1306	1330	1348	1374	1392	1428	1468	1518	1566	Single Fabric	-
			5	1314	1334	1358	1374	1404	1420	1456	1496	1546	1594	-	-
			6	1334	1354	1376	1392	1420	1444	1476	1514	1566	1614	0.75 x2	-
			7	1368	1388	1412	1428	1456	1476	1516	1550	1602	1648	-	-
			8	1408	1428	1452	1468	1496	1514	1550	1596	1640	1688	-	-
9			1460	1480	1502	1518	1546	1566	1602	1640	1698	1740	-	-	
10			1506	1526	1550	1566	1594	1614	1648	1688	1740	1794	-	-	
<b>MYR/A/PIX2</b> Upholstered arm with linking support bracket 2x White Pixel units, 1x power and 2x TUF with a 10' (3m) starter lead.	Single Fabric	-	1892	1934	1982	2014	2070	2110	2182	2262	2364	2460	1.50	-	
	Two Tone 1	-	Top										-	-	
		Bottom	COM /1	1892	1914	1936	1952	1980	2000	2034	2074	2126	2172	-	-
			2	1914	1934	1956	1972	2000	2020	2054	2094	2146	2192	-	-
			3	1936	1956	1982	1996	2024	2042	2078	2118	2168	2216	-	-
			4	1952	1972	1996	2014	2040	2058	2094	2134	2184	2232	Single Fabric	-
			5	1980	2000	2024	2040	2070	2086	2122	2162	2212	2260	-	-
			6	2000	2020	2042	2058	2086	2110	2142	2180	2232	2280	0.75 x2	-
			7	2034	2054	2078	2094	2122	2142	2182	2216	2268	2314	-	-
			8	2074	2094	2118	2134	2162	2180	2216	2262	2306	2354	-	-
9			2126	2146	2168	2184	2212	2232	2268	2306	2364	2406	-	-	
10			2172	2192	2216	2232	2260	2280	2314	2354	2406	2460	-	-	
<b>END ARM UNIT MYR/EA/LH OR MYR/EA/RH (PER ARM).</b> Upholstered end arm available in RH or LH configurations. Also Available with Power	Single Fabric	-	658	700	748	780	836	876	948	1028	1130	1226	1.50	-	
	Two Tone 1	-	Top										-	-	
		Bottom	COM /1	658	680	702	718	746	766	800	840	892	938	-	-
			2	680	700	722	738	766	786	820	860	912	958	-	-
			3	702	722	748	762	790	808	844	884	934	982	-	-
			4	718	738	762	780	806	824	860	900	950	998	Single Fabric	-
			5	746	766	790	806	836	852	888	928	978	1026	-	-
			6	766	786	808	824	852	876	908	946	998	1046	0.75 x2	-
			7	800	820	844	860	888	908	948	982	1034	1080	-	-
			8	840	860	884	900	928	946	982	1028	1072	1120	-	-
9			892	912	934	950	978	998	1034	1072	1130	1172	-	-	
10			938	958	982	998	1026	1046	1080	1120	1172	1226	-	-	

### Painted Leg Options

Color Choice	RAL 9005	RAL 9016	RAL 060 60 05	RAL 240 20 22	RAL 220 70 10	RAL 130 30 20	RAL 040 50 50	RAL 070 70 80
Suffix*	PF/B	PF/W	PF/SG	PF/DB	PF/LB	PF/GN	PF/CR	PF/Y
Painted Legs (or Collar) Price Per Unit	inc	inc	76	76	76	76	76	76



To view the 2D line drawings for the options shown here, please scan or click this QR code